

DÜZ FLANŞ PN 64  
FLANGE WELD ON PIPE PN 64  
TS - EN 1092 - 1  
TİP 01 / TYPE 01  
DIN2576

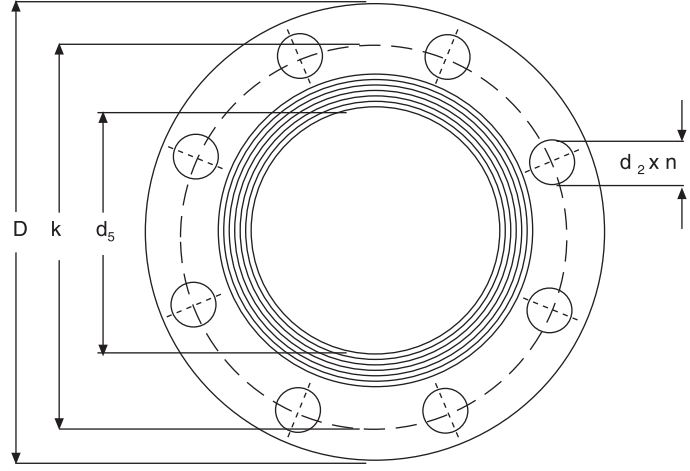
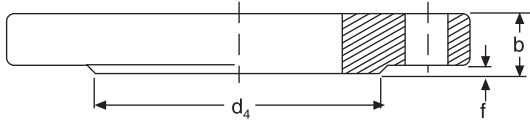

BORU / PIPE	FLANŞ / FLANGE				ALIN ÇIKTISI/RAISED FACE	DELİKLER / DRILLINGS				AĞIRLIK (WEIGHT)		
DN	D <sub>5</sub>	D	b		K	d <sub>4</sub>	f	n	VİDA (SCREW)	d <sub>2</sub>	EN1092-1	DIN2501
			EN1092-1	DIN2501								
15	22	105	20	20	75	45	2	4	M12	14	1,10	1,10
20	27,5	130	22	22	90	58	2	4	M16	18	1,86	1,86
25	34,5	140	24	24	100	68	2	4	M16	18	2,37	2,37
32	43,5	155	24	24	110	78	3	4	M20	22	2,70	2,70
40	49,5	170	26	26	125	88	3	4	M20	22	3,60	3,60
50	61,5	180	26	26	135	102	3	4	M20	22	3,90	3,90
65	77,5	205	26	26	160	122	3	8	M20	22	4,70	4,70
80	90,5	215	30	28	170	138	3	8	M20	22	5,90	5,50
100	116	250	32	30	200	162	3	8	M24	26	8,00	7,50
125	141,5	295	34	34	240	188	3	8	M27	30	11,70	11,70
150	170,5	345	36	36	280	218	3	8	M30	33	16,90	16,90
200	221,5	415	48	42	345	285	3	12	M33	36	30,50	26,50
250	276,5	470	55	46	400	345	3	12	M33	36	42,20	35,00
300	327,5	530	65	52	460	410	4	16	M33	36	59,00	46,80
350	359,5	600	72	56	525	465	4	16	M36	39	88,70	68,30
400	411	670	80	60	585	535	4	16	M39	42	120,90	89,90
500	513,5	800	MÜŞTERİ İSTEĞİ ÜZERİNE BELİRNELECEKTİR.	60	705	615	4	20	M45	48	-	117,00
600	616,5	930		62	820	735	5	20	M52	56	-	155,00
700	718	1045		68	935	840	5	24	M52	56	-	203,00
800	819	1165		76	1050	960	5	24	M58	62	-	270,00
900	920	1285		84	1170	1070	5	28	M58	62	-	352,00
1000	1022	1415		92	1290	1180	5	28	M66	70	-	454,00
1200	1226	1665		100	1530	1380	5	32	M74	78	-	646,00

\*Ölçüler mm'dir.

\*Dimensions are in mm.