

KÖR FLANŞ PN 25
BLIND FLANGE PN 25
TS - EN 1092 - 1
TS - EN 1092 - 2
DIN 2527
TİP05 / TYPE 05

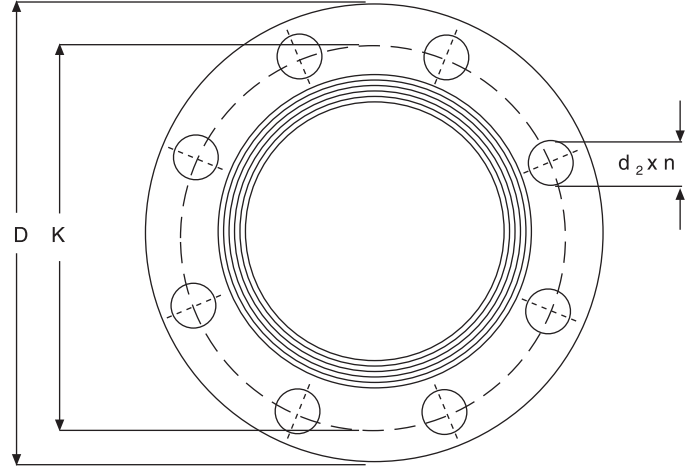
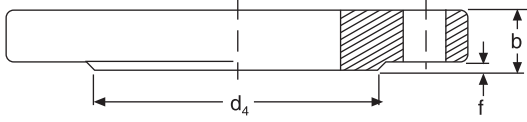

| BORU / PIPE | FLANŞ / FLANGE | | | | | ALIN ÇIKTI/RAISED FACE | | DELİKLER / DRILLINGS | | | AĞIRLIK (WEIGHT) | | |
|-------------|----------------|----------|-----------|---------|------|------------------------|----------------|----------------------|-----|--------------|------------------|----------|-----------|
| | DN | D | b | | | K | d ₄ | f | n | VİDA (SCREW) | d ₂ | EN1092-1 | EN 1092-2 |
| | | EN1092-1 | EN 1092-2 | DIN2527 | | | | | | | | | |
| 15 | 95 | 16 | 16 | 16 | 65 | 45 | 2 | 4 | M12 | 14 | 0,80 | 0,80 | 0,80 |
| 20 | 105 | 18 | 16 | 18 | 75 | 58 | 2 | 4 | M12 | 14 | 1,10 | 1,00 | 1,10 |
| 25 | 115 | 18 | 18 | 18 | 85 | 68 | 2 | 4 | M12 | 14 | 1,30 | 1,30 | 1,30 |
| 32 | 140 | 18 | 19 | 18 | 100 | 78 | 2 | 4 | M16 | 18 | 2,00 | 2,10 | 2,00 |
| 40 | 150 | 18 | 19 | 18 | 110 | 88 | 3 | 4 | M16 | 18 | 2,20 | 2,30 | 2,20 |
| 50 | 165 | 20 | 19 | 20 | 125 | 102 | 3 | 4 | M16 | 18 | 3,00 | 2,80 | 3,00 |
| 65 | 185 | 22 | 19 | 22 | 145 | 122 | 3 | 8 | M16 | 18 | 4,20 | 3,60 | 4,20 |
| 80 | 200 | 24 | 19 | 24 | 160 | 138 | 3 | 8 | M16 | 18 | 5,50 | 4,30 | 5,50 |
| 100 | 235 | 24 | 19 | 24 | 190 | 162 | 3 | 8 | M20 | 22 | 7,60 | 5,90 | 7,60 |
| 125 | 270 | 26 | 19 | 26 | 220 | 188 | 3 | 8 | M24 | 26 | 10,90 | 7,80 | 10,90 |
| 150 | 300 | 28 | 20 | 28 | 250 | 218 | 3 | 8 | M24 | 26 | 14,70 | 10,20 | 14,70 |
| 200 | 360 | 30 | 22 | 30 | 310 | 278 | 3 | 12 | M24 | 26 | 22,90 | 16,50 | 22,90 |
| 250 | 425 | 32 | 24,5 | 32 | 370 | 335 | 3 | 12 | M27 | 30 | 34,20 | 25,90 | 34,20 |
| 300 | 485 | 34 | 27,5 | 34 | 430 | 395 | 4 | 16 | M27 | 30 | 47,00 | 38,00 | 47,00 |
| 350 | 555 | 38 | 30 | 38 | 490 | 450 | 4 | 16 | M27 | 33 | 69,00 | 54,00 | 69,00 |
| 400 | 620 | 40 | 32 | 40 | 550 | 505 | 4 | 16 | M27 | 36 | 91,00 | 72,00 | 91,00 |
| 450 | 670 | 50 | 34,5 | 42 | 600 | 555 | 4 | 20 | M33 | 36 | 135,00 | 92,00 | 113,00 |
| 500 | 730 | 51 | 36,5 | 45 | 660 | 615 | 4 | 20 | M33 | 36 | 163,00 | 116,00 | 144,00 |
| 600 | 845 | 66 | 42 | 46 | 770 | 720 | 5 | 20 | M36 | 39 | 284,00 | 179,00 | 196,00 |
| 700 | 960 | | 46,5 | 50 | 875 | 820 | 5 | 24 | M39 | 42 | - | 256,00 | 253,00 |
| 800 | 1085 | | 51 | 54 | 990 | 930 | 5 | 24 | M45 | 48 | - | 360,00 | 353,00 |
| 900 | 1185 | | 55,5 | 58 | 1090 | 1030 | 5 | 28 | M45 | 48 | - | 470,00 | 457,00 |
| 1000 | 1320 | | 60 | 60 | 1210 | 1140 | 5 | 28 | M52 | 56 | - | 630,00 | 609,00 |
| 1100 | 1420 | | 64,5 | 64 | 1310 | 1240 | 5 | 32 | M52 | 56 | - | 787,00 | 731,00 |
| 1200 | 1530 | | 69 | 70 | 1420 | 1350 | 5 | 32 | M52 | 56 | - | 979,00 | 907,00 |
| 1300 | 1640 | | 72 | 72 | 1530 | 1455 | 5 | 32 | M56 | 62 | - | 1176,00 | 1142,00 |
| 1400 | 1755 | | 74 | 76 | 1640 | 1560 | 5 | 36 | M56 | 62 | - | 1385,00 | 1347,00 |
| 1500 | 1845 | | 77,5 | 80 | 1740 | 1670 | 5 | 36 | M56 | 62 | - | 1640,00 | 1608,00 |
| 1600 | 1975 | | 81 | 88 | 1860 | 1780 | 5 | 40 | M56 | 62 | - | 1925,00 | 1901,00 |
| 1800 | 2195 | | 88 | 95 | 2070 | 1985 | 5 | 44 | M64 | 70 | - | 2586,00 | 2586,00 |

*Ölçüler mm'dir.

*Dimensions are in mm.